

# DAXTON

## CAPACITY CHART & FLOOR PLAN

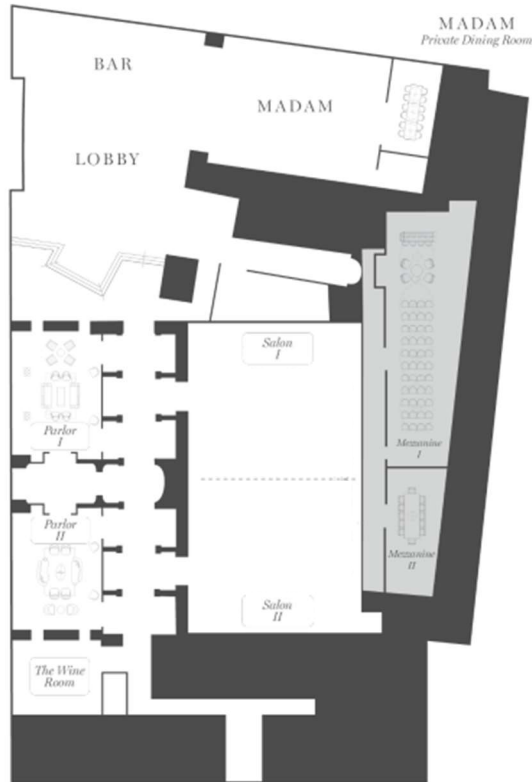

Please note that due to local regulations, our maximum event capacities may be limited to protect guests' and associates' health and safety. Your Daxton Hotel representative can provide more information and address any concerns you may have. Regardless of the size of your event, the Daxton team is dedicated to making sure your gathering happens without a hitch.

Maximum capacities listed below do not include space for additional setup needs. Refer to Sales Manager for your specific event needs.

	<b>SQ FT DIMENSIONS (LxWxH)</b>	<b>OVALS</b>	<b>WEDDING</b>	<b>CONFERENCE</b>	<b>THEATER</b>	<b>CLASSROOM</b>	<b>U-SHAPE</b>	<b>HOLLOW SQUARE</b>	<b>STROLLING (STANDING)</b>	<b>STROLLING (SEATED)</b>
<b>SALON I</b>	1,886: 46'x41' 10'2" to chandelier	130	80	32	176	72	38	48	200	80
<b>SALON II</b>	1,886: 46'x41' 10'2" to chandelier	130	80	32	176	72	38	48	200	80
<b>FULL SALON</b>	3,772: 82'x46' 10'2" to chandelier	260	250		450	144			498	275
<b>PARLOR I</b>	662: 32'7"x20'4"x16" 11'8" to chandelier	40		20	43	24	21	24	40	30
<b>PARLOR II</b>	638: 31'5"x20'4"x16" 11'8" to chandelier	40		20	43	24	21	24	40	30
<b>WINE ROOM</b>	425: 19'5"x21'11"x16"			12						
<b>PRIVATE DINING ROOM</b>	263: 22'1.5"x11'11"x20' 7'7" to chandelier			12						
<b>MEZZANINE I</b>	1,235: 65'x16' narrow end-22' wide end x8'	50		32	72	40	32	30	80	50
<b>MEZZANINE II</b>	418: 31'x12' narrow end-15' wide end x8'			14						