

DAXTON

CAPACITY CHART & FLOOR PLAN

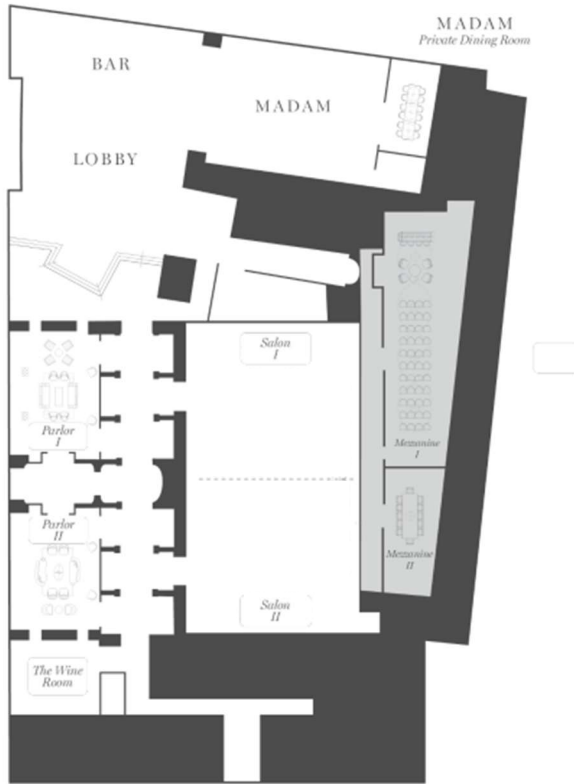

Please note that due to local regulations, our maximum event capacities may be limited to protect guests' and associates' health and safety. Your Daxton Hotel representative can provide more information and address any concerns you may have. Regardless of the size of your event, the Daxton team is dedicated to making sure your gathering happens without a hitch.

Maximum capacities listed below do not include space for additional setup needs. Refer to Sales Manager for your specific event needs.

| | SQ. FT. / CEILING HEIGHT | OVALS | WEDDING | CONFERENCE | THEATER | CLASSROOM | U-SHAPE | HOLLOW SQUARE | STROLLING (STANDING) | STROLLING (SEATED) |
|---------------------------|--------------------------------|-------|---------|------------|---------|-----------|---------|------------------|-------------------------|-----------------------|
| SALON I | 1909 18' | 80 | 50 | 28 | 144 | 60 | 30 | 40 | 60 | 50 |
| SALON II | 1909 18' | 80 | 50 | 28 | 144 | 60 | 30 | 40 | 60 | 50 |
| FULL SALON | 3818 18' | 240 | 210 | - | 270 | 120 | - | - | 120 | 100 |
| | | | | | | | | | | |
| PARLOR I | 672 | 40 | - | 20 | 40 | 24 | 18 | 20 | 40 | 30 |
| PARLOR II | 632 | 40 | - | 20 | 40 | 24 | 16 | 18 | 40 | 30 |
| THE WINE ROOM | 387 | - | - | 12 | - | - | - | - | - | - |
| PRIVATE DINING ROOM | 231 | - | - | 12 | - | - | - | - | - | - |
| | | | | | | | | | | |
| MEZZANINE I | 1326 | 40 | - | 32 | 50 | 40 | 32 | 24 | 50 | 40 |
| MEZZANINE II | 444 31'x 14' 8' | - | - | 12 | - | - | - | - | - | - |